



LOG AND LUMBER HANDLING SYSTEMS

WD110 LOG TROUGH



WD110 LOG TROUGH WITH DRIVE

OPTIONAL:
SINGLE OR DOUBLE KICKOFF
AIR OR HYDRAULIC CYLINDERS
MANUAL OR AUTOMATIC CONTROLS

FEATURES

- The Mellott Log Trough conveyor is designed to move logs lengthwise.
- They can be equipped with kickoffs to the right, left, or both sides.
- The kickers are available with automatic or manual controls.
- The kicker functions can be configured for either air or hydraulic operation.
- Drive options include electric motor with foot mounted speed reducer or a hydraulic motor using a chain drive .
- The log chain is WD110 which travels on AR plate steel (UHMW wear strip optional).
- The conveyor is available in standard lengths of 20' featuring drive, intermediate, and tail sections. Special layouts or design requirements are available.

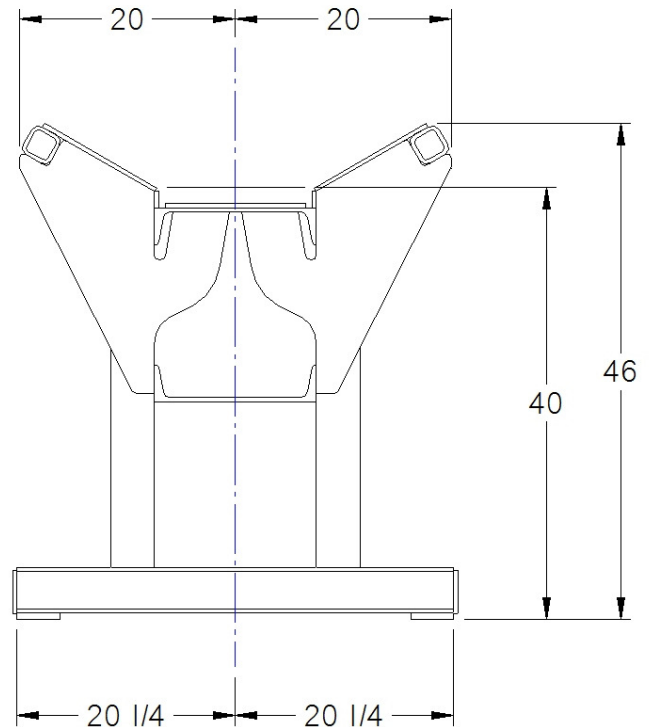

MELLOTT MFG. CO., INC.

13156 Long Lane
Mercersburg, PA 17236
Phone: (717) 369-3125 Fax: (717) 369-2800
sales@mellottmfg.com

www.mellottmfg.com



LOG AND LUMBER HANDLING SYSTEMS

WD110 LOG TROUGH

SPECIFICATIONS

Chain	WD110 Round Barrel
Base Frame.....	W4 x 13 Beam
Chain Way	C15 x 33.9 Channel With 3/8" A.R. Wear Plate
Trough	3/8" Plate With 3/8" Plate Gussets
Log Diameter.....	42" Maximum
Hydraulic Drive.....	Eaton 10,000 Series Motor with 100 Roller Chain
Electric Drive	Sumitomo Foot Mounted Cyclo Reducer With 10 Hp Motor
Shaft Sizes.....	2-15/16"
Speed.....	115 FPM
Wear Plate	3/8" A.R. Plate Standard, UHMW Optional
Kickoff	4 Arm, 1" Flame Cut Plates
Air Kickoff.....	(2) 8" x 12" cylinders per kicker
Hydraulic Kickoff.....	(2) 2 1/2" x 12" cylinders per kicker
Hydraulic Log Jack, Log Clamp, Stop On End, Transition And Reinforcement Are Optional	

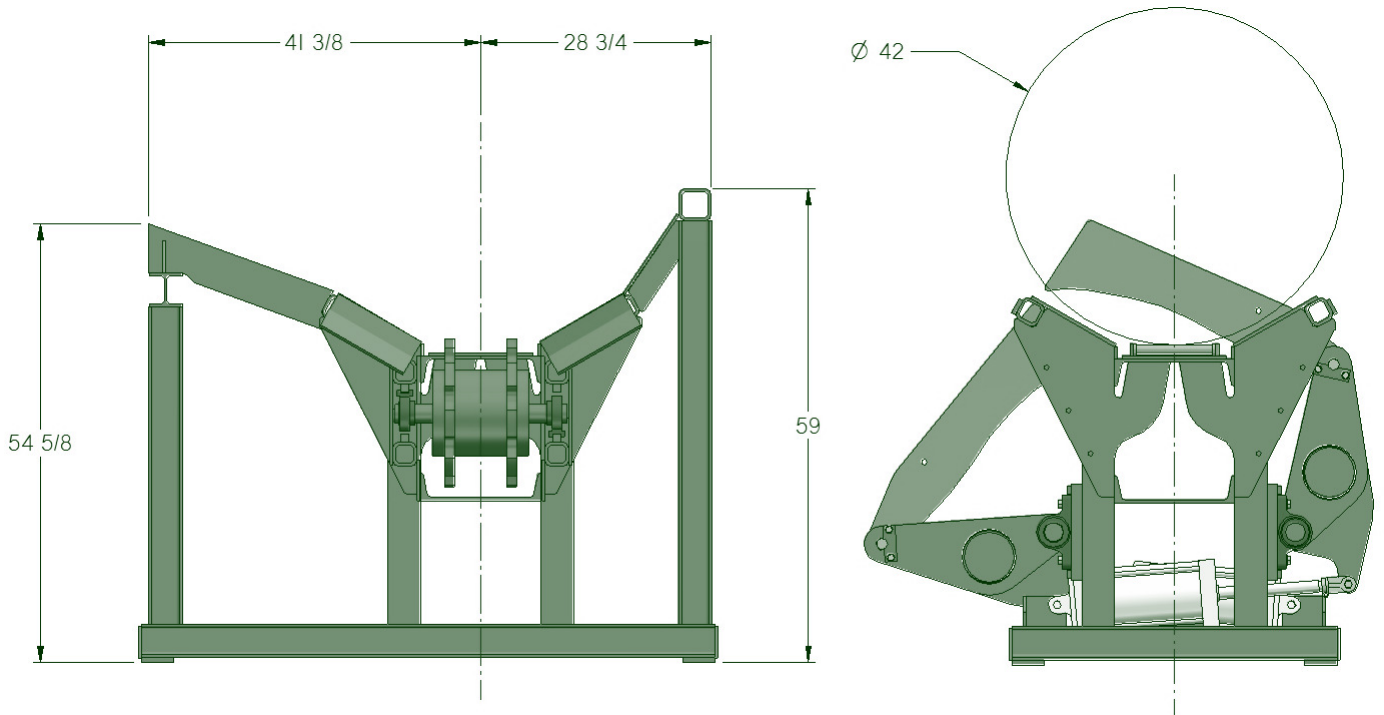

WD110 LOG TROUGH END VIEW WITH TRANSITION, REINFORCEMENT AND DOUBLE AIR OPERATED KICKOFF

MELLOTT MFG. CO., INC.

13156 Long Lane
Mercersburg, PA 17236
Phone: (717) 369-3125 Fax: (717) 369-2800
sales@mellottmfg.com

www.mellottmfg.com