

# Mellott

## LOG AND LUMBER HANDLING SYSTEMS

### 7 TON TILT HOIST



#### FEATURES

The Mellott 7 Ton Tilt Hoist is designed to unstack stickered packages of lumber. The standard machine is designed for 66" high x 72" wide x 18' long packages. Shorter columns and forks are available for smaller packages.

Heavy construction and a simple design are used throughout the 7 Ton Tilt Hoist in order to keep maintenance and down time to a minimum.

- Base frame constructed in two pieces so that the forks can be assembled on the tilt hoist for shipping
- The steel columns are welded to a 10" diameter pivot tube at the bottom and a 3" square tube at the top to tie all the columns together for extra strength
- Dual Lift cylinders are 4" bore, 3000 psi rated cushioned hydraulic cylinder with (2) heavy RC160 roller chains
- Dual heavy leaf chains are used in an "X" arrangement for load leveling
- Tilt cylinders are 4" bore, 3000 psi rated cushioned hydraulic cylinders
- Chain attachments use standard connecting links
- Cylinder arms are 1-1/2" thick flame cut arms that completely wrap the pivot tube
- Steel rollers used in all of the forks in order to distribute the load to all of the columns

Optional conveyors include: Infeed decks, outfeed conveyors, stick removal conveyors and stick stacking systems.

Combined, these conveyors make a reliable, heavy duty tilt hoist system.

[www.mellottmfg.com](http://www.mellottmfg.com)



Lift cylinders are guarded to prevent damage to the cylinders and kiln sticks



Dual Steel lift cylinders with heavy RC160 roller chain

#### MELLOTT MFG. CO., INC.

13156 Long Lane  
Mercersburg, PA 17236  
Phone: (717) 369-3125 Fax: (717) 369-2800  
sales@mellottmfg.com



# LOG AND LUMBER HANDLING SYSTEMS

## 7 TON TILT HOIST

### SPECIFICATIONS

|                                    |  |
|------------------------------------|--|
| Base Frame .....                   | W6 X 25 Beam   |
| Pivot bearings .....               | Type "E" 2 15/16"  |
| Pivot Tube.....                    | 10" Diameter Pipe  |
| Columns.....                       | 6" x 3" x 1/4" wall tubing   |
| Forks .....                        | 6" x 4" x 1/4" wall tubing   |
| Tilt Cylinders.....                | (2) 4" bore X 18" stroke, 3000 psi rated cushioned hydraulic cylinders |
| Lift Cylinder.....                 | (2) 4" bore X 36" stroke, 3000 psi rated cushioned hydraulic cylinders |
| Lift chains.....                   | (2) RC160 roller chains  |
| Tilt Angle .....                   | 45 degrees   |
| Fork Spacing 3 arm .....           | 72", 72"   |
| 4 arm .....                        | 54", 36", 54"  |
| 5 arm .....                        | 24", 24", 36", 60"   |
| Package Size .....                 | 66" high x 72" wide x 18' Maximum                                      |
| Package Weight .....               | 7 ton maximum  |
| Hydraulic requirements.....        | 15 Gpm, pressure compensated @ 2000 psi                                |
| Overall Weight (5 Arm Model) ..... | 11,000 Lbs   |

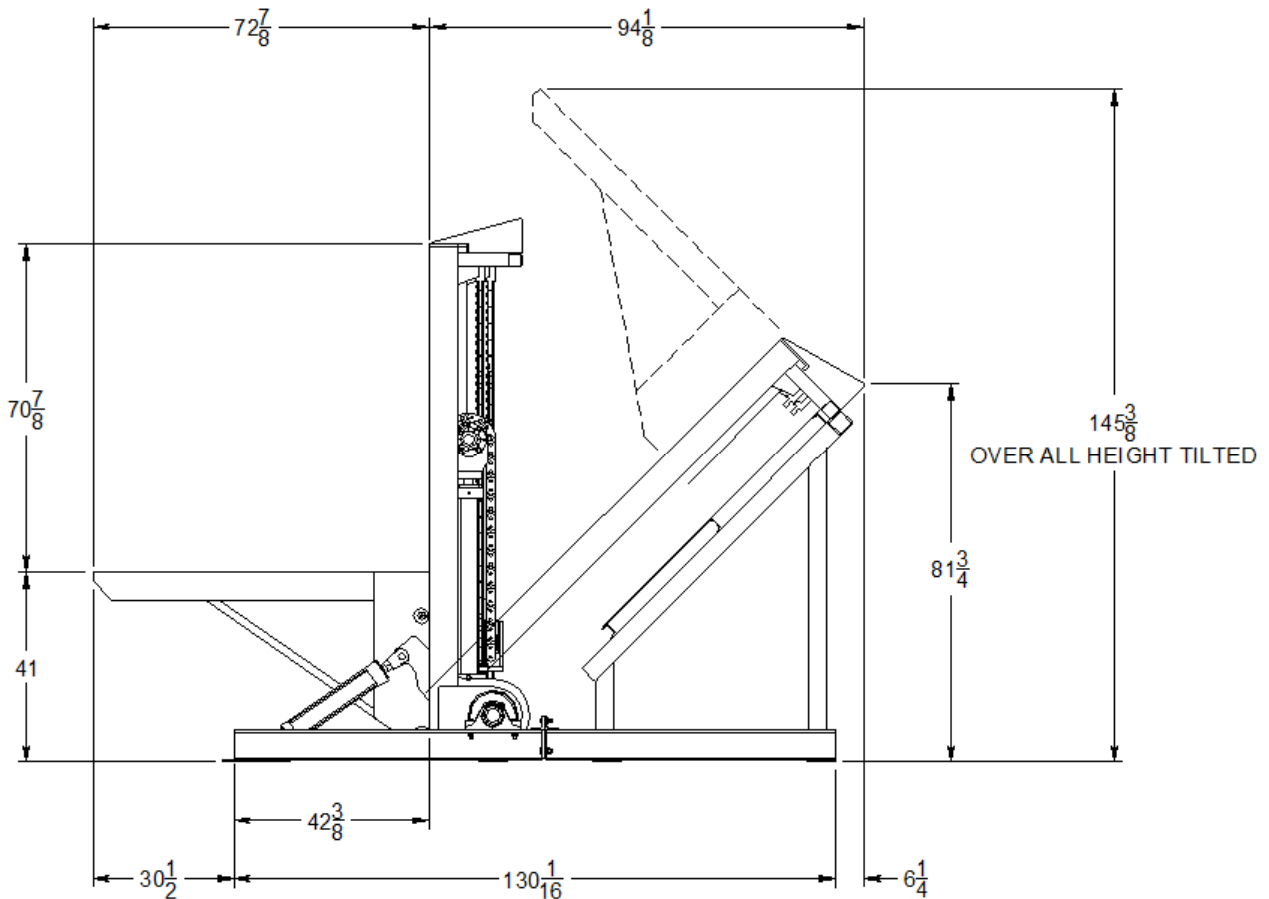

**MELLOTT MFG. CO., INC.**

13156 Long Lane  
 Mercersburg, PA 17236  
 Phone: (717) 369-3125 Fax: (717) 369-2800  
 sales@mellottmfg.com

[www.mellottmfg.com](http://www.mellottmfg.com)